





# I-70 INDUSTRIAL PARK

South Huntingdon Township,  
Westmoreland County, PA

## LOT STATUS

	SOLD
	OPTIONED
	AVAILABLE
	NOT AVAILABLE / BUFFER
	PRIVATE PROPERTY

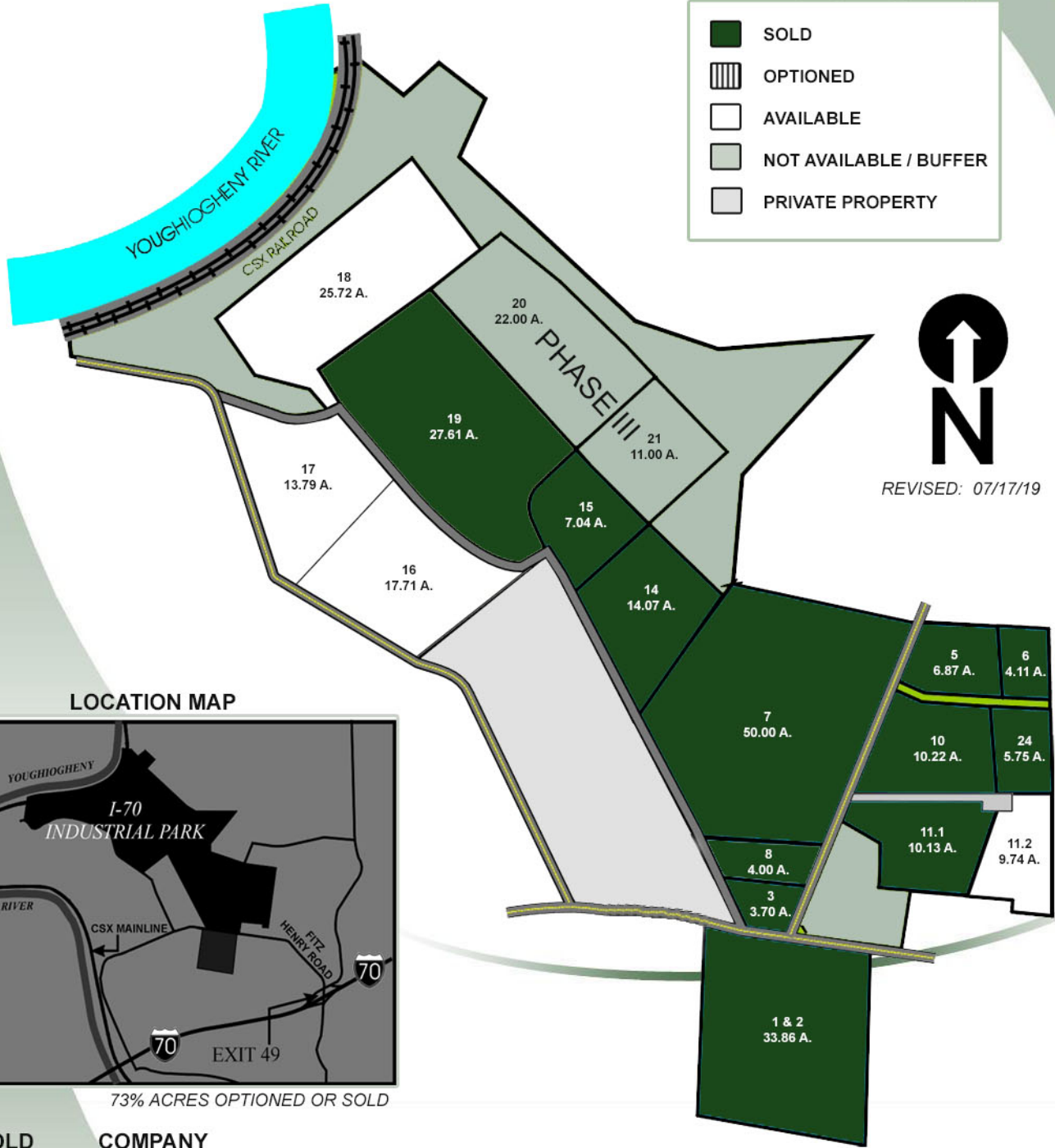

### LOTS SOLD

LOT 1 & 2  
LOT 3  
LOT 5 & 6  
LOT 7 & 14  
LOT 8

LOT 10 & 24  
LOT 11.1  
LOT 15  
LOT 19

### COMPANY

LEVIN FURNITURE COMPANY  
ONE MORE LOAD  
GAS FIELD SPECIALISTS, INC.  
DICK'S SPORTING GOODS  
PROPERTY LEASED FROM PRIVATE OWNER  
FOR 4.0 ACRES  
SUPERIOR ENERGY  
GLADIATOR ENERGY  
TARGET DRILLING INC.  
WENDELL H. STONE COMPANY INC.



Westmoreland County Industrial Development Corporation  
Fifth Floor | Suite 520 | 40 North Pennsylvania Avenue | Greensburg, PA 15601  
phone 724.830.3061 | fax 724.830.3611 | email wcidc@wpa.net

[www.westmorelandcountyidc.org](http://www.westmorelandcountyidc.org)

**I-70 INDUSTRIAL PARK**  
*Designated Pennsylvania Select Site*



**UTILITIES:**

Electric: West Penn Power Company  
Service: 12.5 kV Primary service  
(possible dual service)  
Gas: Columbia Gas  
Gas Line Size: 8"  
Water: Municipal Authority of  
Westmoreland County  
Water Line Size: 12' to park and inside the park  
Sewage: Municipal Authority of  
Westmoreland County  
Sanitary Sewer  
Capacity: 50,000 GPD

**SALE/LEASE:**

Sale:	1-10 Acres	\$26,000 per Acre
	10-15 Acres	\$24,500 per Acre
	15+ Acres	\$21,000 per Acre
	15+ Acres & 100 Jobs	\$20,000 per Acre

**CONTACT:**

Joseph D. Sisley – Marketing Director  
Alicia Henry – Marketing  
Coordinator  
(724) 830-3061  
Email: [wcidc@wpa.net](mailto:wcidc@wpa.net)  
[www.westmorelandcountyidc.org](http://www.westmorelandcountyidc.org)



The location and topography of this park is expected to attract warehousing, distribution and manufacturing companies.

NOTE: Information shown is purported to be from reliable sources. No representation is made to the accuracy thereof, and is submitted subject to errors, omissions, change in price, prior sale, withdrawal notice, or other conditions.



**LOCATION:**

Address: Glacier Drive  
Smithton, PA 15479  
Municipality: South Huntingdon Township  
Latitude: 40° 11'  
Longitude: 79° 45'

**DESCRIPTION:**

Total Acreage: 600 acres  
Total Acreage Sold: 177.36 Acres  
Total Acreage Optioned: 0 Acres  
Acreage Available: 9.74 Acres (Phase I)  
57.22 Acres (Phase II)  
Zoned: Not Applicable  
Topography: Level to gently sloping

**TRANSPORTATION:**

Nearest Highway: Interstate 70, Exit 49 – ¾ of a mile  
PA Turnpike Exit 75, New Stanton – 8 miles  
Nearest Airport: Allegheny County Airport – 15 miles  
Rail Assessable: No  
Closest Port: Pittsburgh

**GENERAL INFORMATION:**

2019  
Millage Rate: South Huntingdon Twp – 115.33 Mills  
Nearest Fire  
Company: Turkeytown VFD – 3 miles  
Distance to Landfill: 4 miles