

# WESTMORELAND DISTRIBUTION PARK EAST/WEST

East Huntingdon Township,  
Westmoreland County, PA

LOCATION MAP

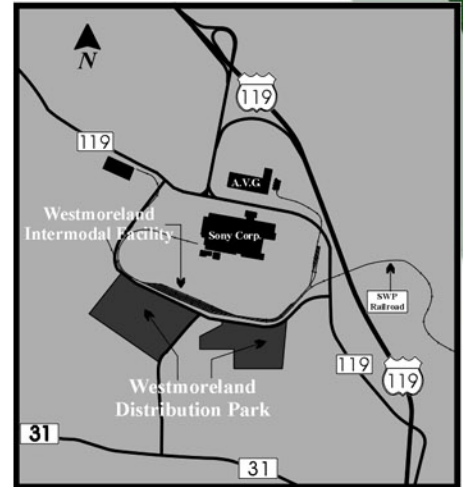

83% ACRES OPTIONED OR SOLD

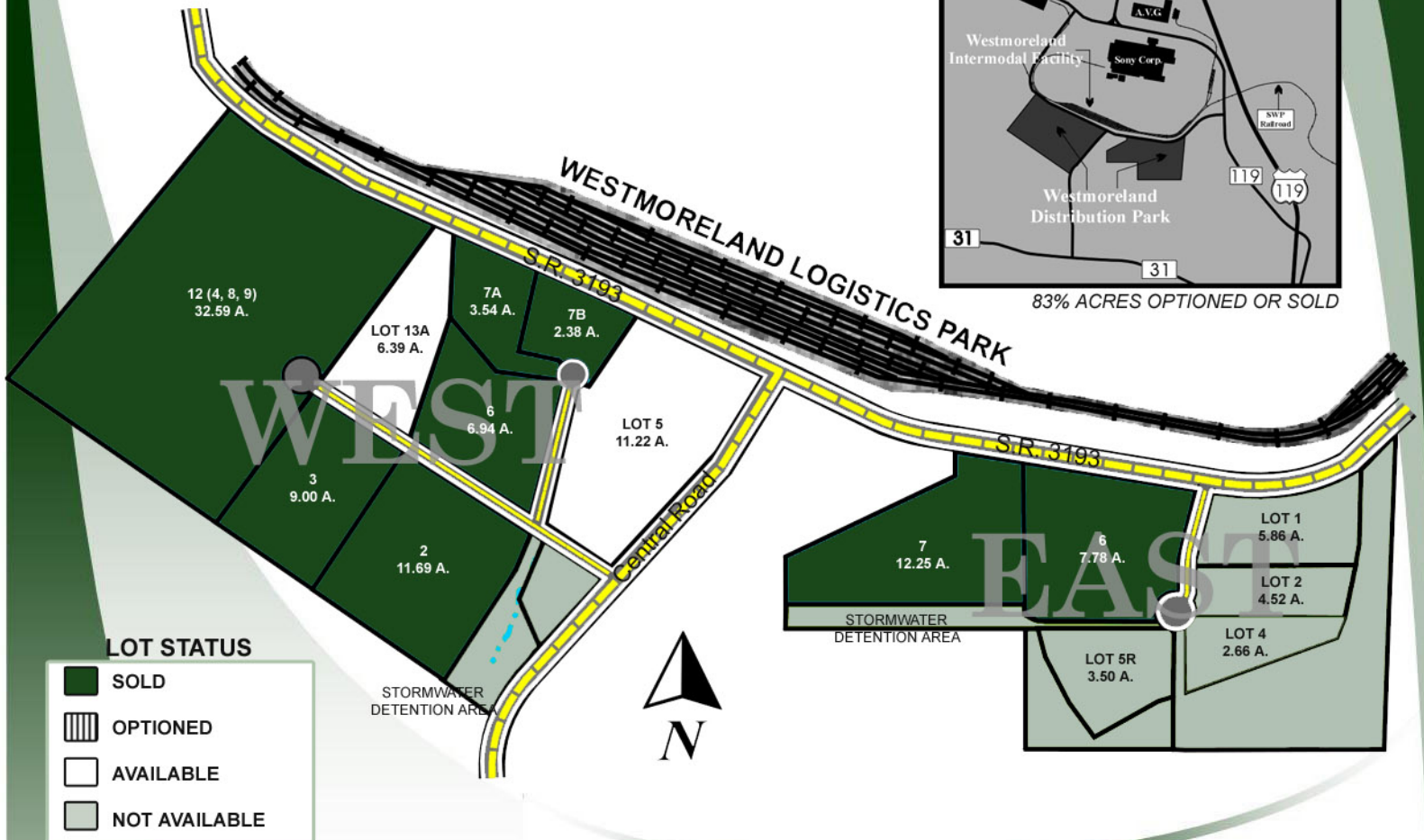

  
**N**  
 REVISED: 07/16/12

**LOTS SOLD**

- LOT 3 (West)
- LOT 7A (West)
- LOT 6 & 7 (East)
- LOT 4, 8A & 9 (West)
- LOT 7B (West)
- LOT 6 (West)
- LOT 2 (West)

**COMPANY**

- FED EX
- ONE CALL RENTALS
- ABB, INC.
- REINHART FOOD SERVICE
- REUSS ENGINEERS, INC.
- RECO EQUIPMENT
- PENSKE TRUCK LEASING COMPANY

**LOTS OPTIONED**

**COMPANY**



Westmoreland County Industrial Development Corporation  
Fifth Floor | Suite 520 | 40 North Pennsylvania Avenue | Greensburg, PA 15601  
phone 724.830.3061 | fax 724.830.3611 | email wcidc@wpa.net

[www.westmorelandcountyidc.org](http://www.westmorelandcountyidc.org)

**WESTMORELAND DISTRIBUTION PARK EAST/WEST**  
*Designated Pennsylvania Select Site*



Gas: Peoples Natural Gas  
Gas Line Size: 8"  
Water: Municipal Authority of Westmoreland County  
Water Line Size: 20" line to the park  
8" Interior line  
Sewage: Public  
Fiber Optic: Yes

**GENERAL INFORMATION:**

2011  
Millage Rate: East Huntingdon Twp. – 92.64 mills  
Nearest Fire Company: East Huntingdon Twp. Fire Dept. – 1 mile  
Distance to Landfill: 6 miles

**SALE/LEASE:**

Sale: \$35,000 per acre

**CONTACT:**



Joseph D. Sisley – Marketing Director

Ben Wentzel – Business Development

Director

(724) 830-3061

email: [wcidc@wpa.net](mailto:wcidc@wpa.net)

[www.westmorelandcountyyidc.org](http://www.westmorelandcountyyidc.org)

**NOTE:** Information shown is purported to be from reliable sources. No representation is made to the accuracy thereof, and is submitted subject to errors, omissions, change in price, prior sale, withdrawal notice, or other conditions.

**The SMART CHOICE**  
... for your business expansion!

**LOCATION:**

Address: SR 3193 and Central Road  
Mt. Pleasant, PA 15666  
Municipality: East Huntingdon Township  
Latitude: 40° 11'  
Longitude: 79° 34'

**DESCRIPTION:**

Total Acreage: 154±  
Sellable Acreage: 125.75 acres  
Number of Lots: 15  
Maximum Lot Size: 12.25 acres  
Minimum lot size: 2.38 acres  
Acreage Available: 17.61 acres  
Number of Lots Available: 2  
Zoned: Light Industrial  
Topography: Gently Sloping

**TRANSPORTATION:**

Nearest Highway: U.S. Route 119 - <1 mile  
PA Turnpike, New Stanton – 2 miles  
Nearest Airport: Arnold Palmer Regional Airport – 15 miles  
Rail Accessible: Westmoreland Logistics Park – Rail Freight Terminal within close proximity  
Closest Port: Pittsburgh

**UTILITIES:**

Electric: West Penn Power Company  
Service: 12.5 kV Primary service through the park

